



# SPN3055 N-Channel Enhancement Mode MOSFET

## DESCRIPTION

The SPN3055 is the N-Channel logic enhancement mode power field effect transistors are produced using high cell density , DMOS trench technology.

This high density process is especially tailored to minimize on-state resistance. These devices are particularly suited for low voltage application, such as DC/DC converter and Desktop computer power management.

The package is universally preferred for commercial industrial surface mount applications

## FEATURES

- ◆ 30V/12A,  $R_{DS(ON)}=60m\Omega@V_{GS}=10V$
- ◆ 30V/6A,  $R_{DS(ON)}=80m\Omega@V_{GS}=4.5V$
- ◆ Super high density cell design for extremely low  $R_{DS(ON)}$
- ◆ Exceptional on-resistance and maximum DC current capability
- ◆ TO-252-2L package design

## APPLICATIONS

- Power Management in Desktop Computer
- DC/DC Converter
- LCD Display inverter

## PIN CONFIGURATION ( TO-252-2L )

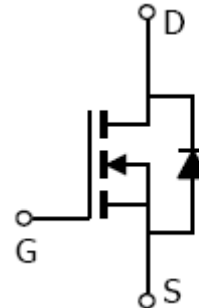
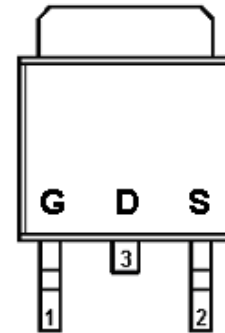

## PART MARKING





# SPN3055

## N-Channel Enhancement Mode MOSFET

### PIN DESCRIPTION

Pin	Symbol	Description
1	G	Gate
2	S	Source
3	D	Drain

### ORDERING INFORMATION

Part Number	Package	Part Marking
SPN3055T252RG	TO-252-2L	SPN3055
SPN3055T252RGB	TO-252-2L	SPN3055

※ SPN3055T252RG : Tape Reel ; Pb – Free

※ SPN3055T252RGB : Tape Reel ; Pb – Free ; Halogen - Free

### ABSOLUTE MAXIMUM RATINGS

(TA=25°C Unless otherwise noted)

Parameter	Symbol	Typical	Unit	
Drain-Source Voltage	V <sub>DSS</sub>	30	V	
Gate –Source Voltage	V <sub>GSS</sub>	±20	V	
Continuous Drain Current(T <sub>J</sub> =150°C)	I <sub>D</sub>	TA=25°C	12	A
		TA=70°C	8	
Pulsed Drain Current	I <sub>DM</sub>	20	A	
Continuous Source Current(Diode Conduction)	I <sub>S</sub>	12	A	
Power Dissipation	P <sub>D</sub>	TA=25°C	40	W
		TA=70°C	20	
Operating Junction Temperature	T <sub>J</sub>	-55/150	°C	
Storage Temperature Range	T <sub>STG</sub>	-55/150	°C	
Thermal Resistance-Junction to Ambient	R <sub>θJA</sub>	100	°C/W	



# SPN3055

## N-Channel Enhancement Mode MOSFET

### ELECTRICAL CHARACTERISTICS

(TA=25°C Unless otherwise noted)

Parameter	Symbol	Conditions	Min.	Typ	Max.	Unit
<b>Static</b>						
Drain-Source Breakdown Voltage	$V_{(BR)DSS}$	$V_{GS}=0V, I_D=-250\mu A$	30			V
Gate Threshold Voltage	$V_{GS(th)}$	$V_{DS}=V_{GS}, I_D=-250\mu A$	1.0		3.0	
Gate Leakage Current	$I_{GSS}$	$V_{DS}=0V, V_{GS}=\pm 20V$			$\pm 100$	nA
Zero Gate Voltage Drain Current	$I_{DSS}$	$V_{DS}=24V, V_{GS}=0V$			1	uA
		$V_{DS}=24V, V_{GS}=0V$ $T_J=85^\circ C$			10	
Drain-Source On-Resistance	$R_{DS(on)}$	$V_{GS}=10V, I_D=12A$		0.050	0.06	$\Omega$
		$V_{GS}=4.5V, I_D=6A$		0.067	0.080	
Forward Transconductance	$g_{fs}$	$V_{DS}=10V, I_D=12A$		20		S
Diode Forward Voltage	$V_{SD}$	$I_S=6A, V_{GS}=0V$		1.0	1.2	V
<b>Dynamic</b>						
Total Gate Charge	$Q_g$	$V_{DS}=15V, V_{GS}=10V$ $I_D=12A$		4.5	10	nC
Gate-Source Charge	$Q_{gs}$			0.8		
Gate-Drain Charge	$Q_{gd}$			1.0		
Input Capacitance	$C_{iss}$	$V_{DS}=15V, V_{GS}=0V$ $f=1MHz$		240		pF
Output Capacitance	$C_{oss}$			110		
Reverse Transfer Capacitance	$C_{rss}$			17		
Turn-On Time	$t_{d(on)}$	$V_{DD}=15V, R_L=15\Omega$ $I_D=1.0A, V_{GEN}=10V$ $R_G=6\Omega$		8	20	ns
	$t_r$			12	30	
Turn-Off Time	$t_{d(off)}$			17	35	
	$t_f$			8	20	



# SPN3055

## N-Channel Enhancement Mode MOSFET

### TYPICAL CHARACTERISTICS

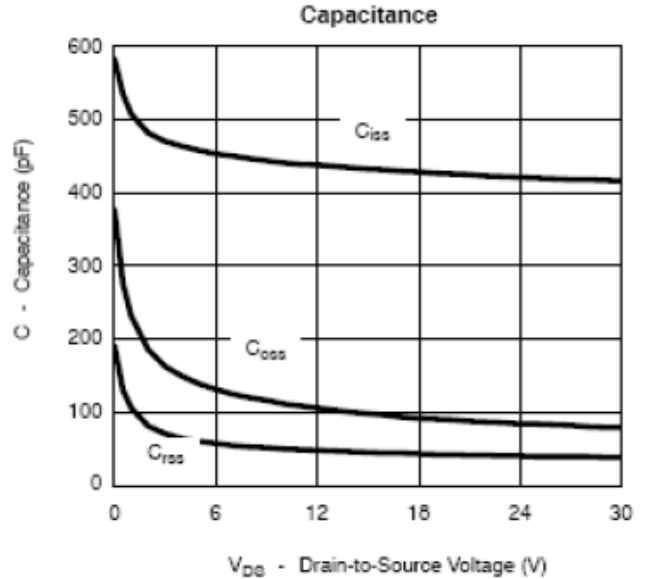
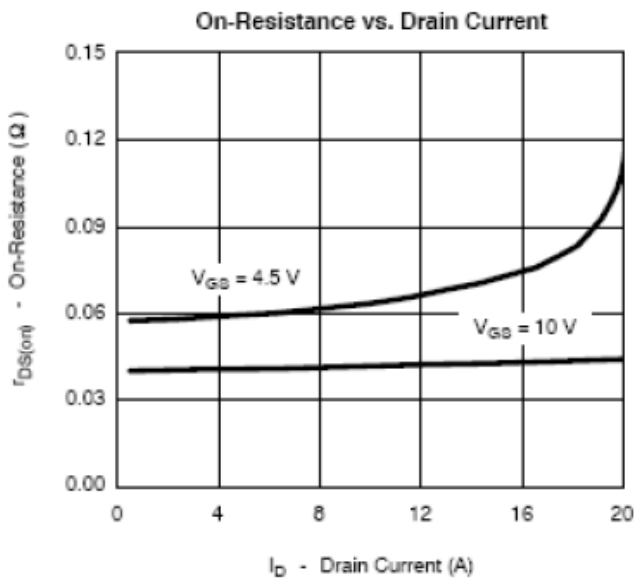
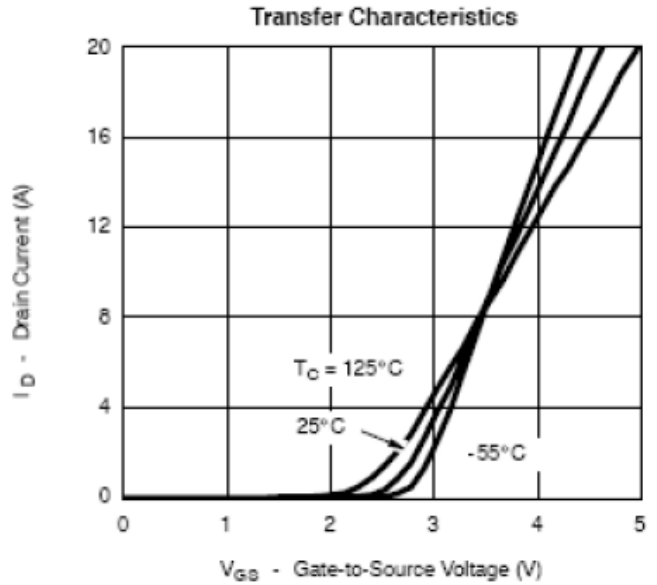
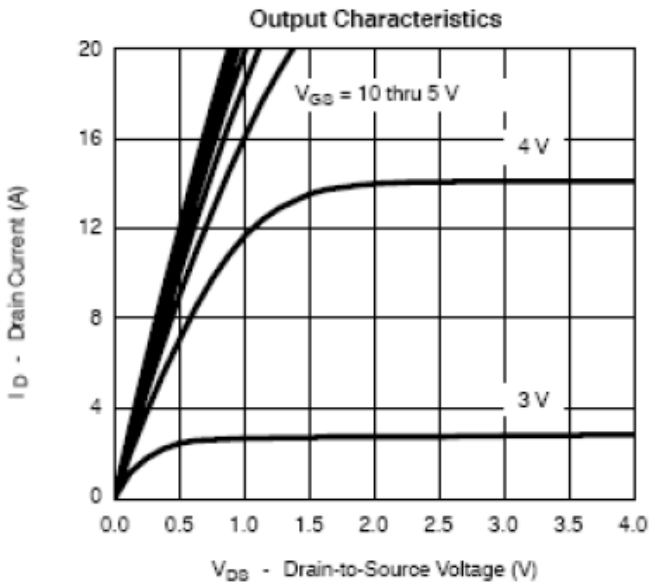



# SPN3055 N-Channel Enhancement Mode MOSFET

## TYPICAL CHARACTERISTICS

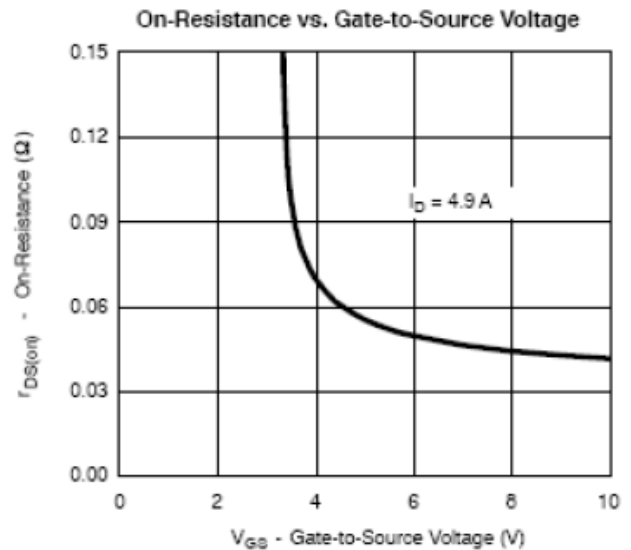
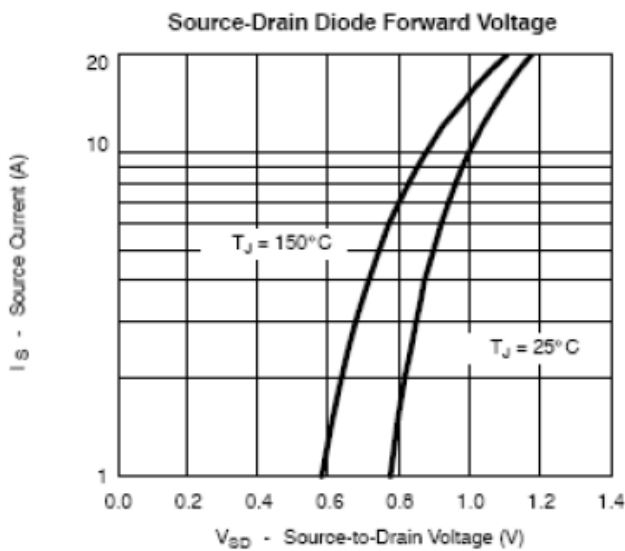
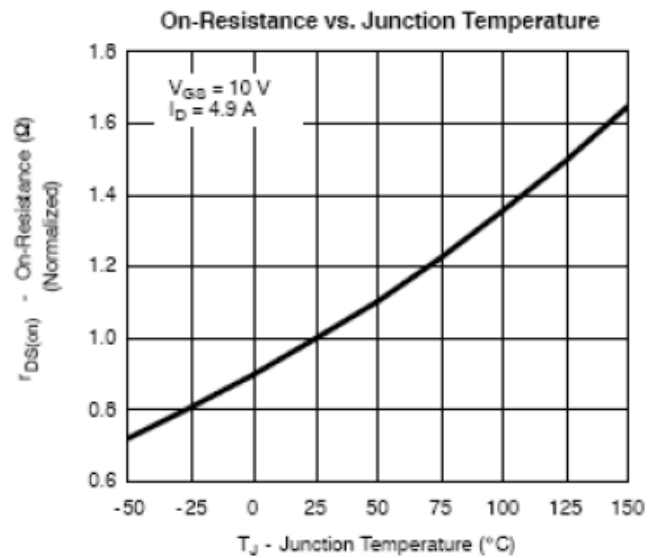
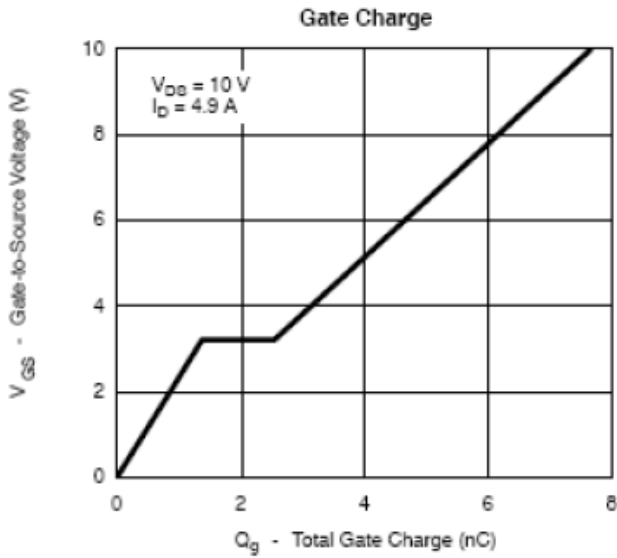



# SPN3055

## N-Channel Enhancement Mode MOSFET

### TYPICAL CHARACTERISTICS

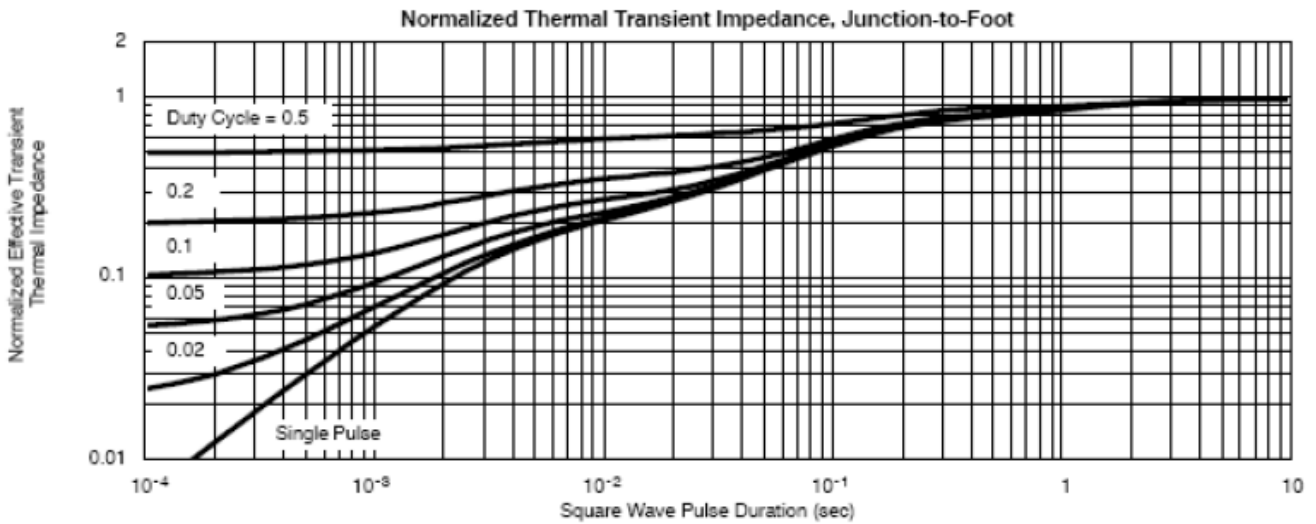
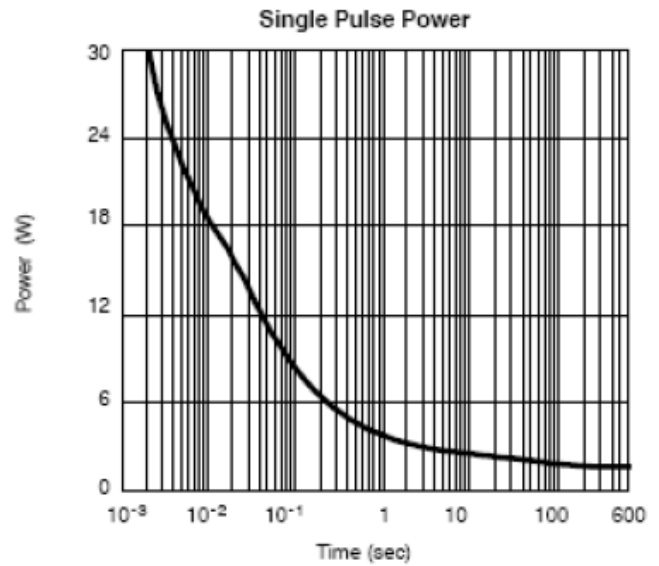
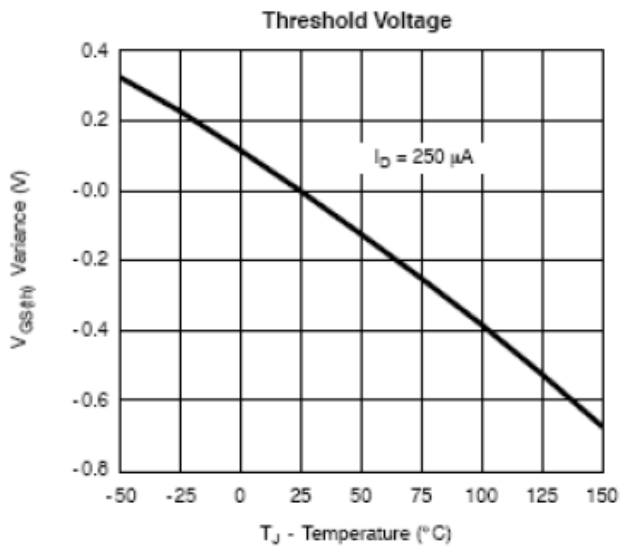



# SPN3055

## N-Channel Enhancement Mode MOSFET

### TO-252-2L PACKAGE OUTLINE

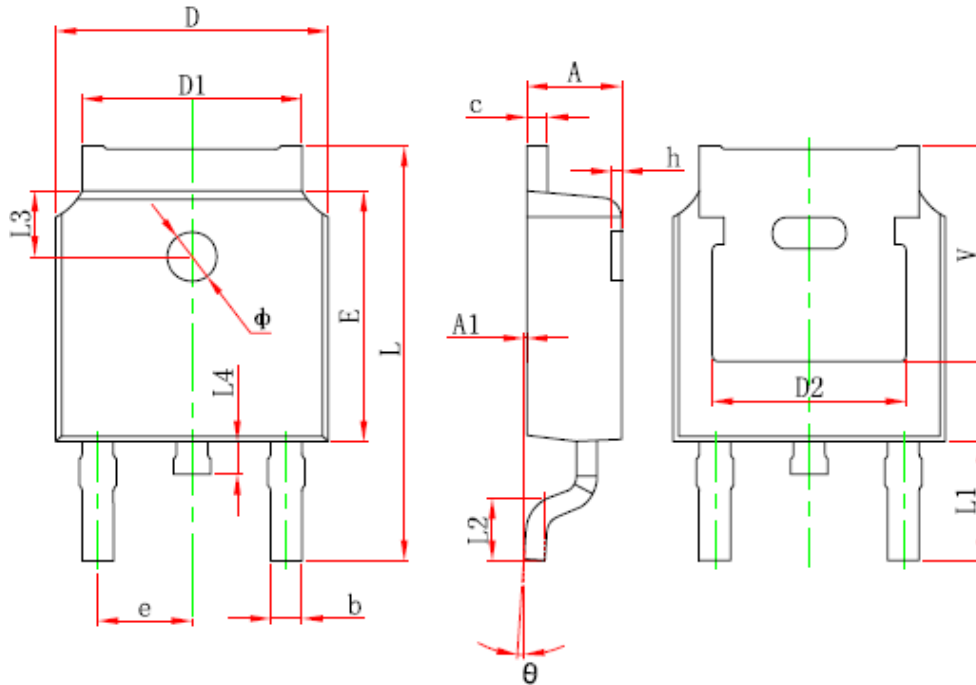

Symbol	Dimensions In Millimeters		Dimensions In Inches	
	Min.	Max.	Min.	Max.
A	2.200	2.400	0.087	0.094
A1	0.000	0.127	0.000	0.005
b	0.660	0.860	0.026	0.034
c	0.460	0.580	0.018	0.023
D	6.500	6.700	0.256	0.264
D1	5.100	5.460	0.201	0.215
D2	4.830 REF.		0.190 REF.	
E	6.000	6.200	0.236	0.244
e	2.186	2.386	0.086	0.094
L	9.800	10.400	0.386	0.409
L1	2.900 REF.		0.114 REF.	
L2	1.400	1.700	0.055	0.067
L3	1.600 REF.		0.063 REF.	
L4	0.600	1.000	0.024	0.039
φ	1.100	1.300	0.043	0.051
θ	0°	8°	0°	8°
h	0.000	0.300	0.000	0.012
V	5.350 REF.		0.211 REF.	



# SPN3055

## N-Channel Enhancement Mode MOSFET

---

Information provided is alleged to be exact and consistent. SYNC Power Corporation presumes no responsibility for the penalties of use of such information or for any violation of patents or other rights of third parties which may result from its use. No license is granted by allegation or otherwise under any patent or patent rights of SYNC Power Corporation. Conditions mentioned in this publication are subject to change without notice. This publication surpasses and replaces all information previously supplied. SYNC Power Corporation products are not authorized for use as critical components in life support devices or systems without express written approval of SYNC Power Corporation.

©The SYNC Power logo is a registered trademark of SYNC Power Corporation

©2004 SYNC Power Corporation – Printed in Taiwan – All Rights Reserved

SYNC Power Corporation

7F-2, No.3-1, Park Street

NanKang District (NKSP), Taipei, Taiwan 115

Phone: 886-2-2655-8178

Fax: 886-2-2655-8468

©<http://www.syncpower.com>